



PALM VILLAGER

A PUBLICATION OF PALM VILLAGE RETIREMENT COMMUNITY • MAY, 2011

SPRING HAS SPRUNG: THE “LIVING” LEGACY

There is a story we tell in Reedley, each year at this time. It is the story of spring. It's truly a “Living Legacy”. Pollinated blossom trails give way to leaves on trees and fruit buds maturing into actual pieces of potential harvest.

Soon there are thinning crews in orchards of all kinds, and the ground is littered with fruit that will give way to the potential larger and more profitable yields, and more edible,

sweet peaches, plums, nectarines, and much more that makes this valley come alive with the good tastes of harvest.

Yet, alongside that story, we watch the storm clouds grow and wonder if it will hail as the fruit begins to take shape on the trees. As dark clouds sometimes gather, and rain turns to hail, we hear the “boom, boom, boom” of hail cannons trying to minimize the potential damage. By around mid-May, this season of spring and uncertainty yields to our summer, and the fruit begins to be packaged and shipped around the world.

These cycles have been going on around Reedley and surrounding areas for the better part of 100 years. It is an incredible time of risk, growth and change that also usually coincides with Easter. Dormancy, gives way to life. It's an old story, repeated and experienced over and over again. We gladly keep showing up for it!

At Palm Village, we also enjoy our own seasons and cycles that coincide with those



SPRING HAS SPRUNG: THE “LIVING” LEGACY

we live around. Our facility takes on the new life of the colors of spring. Our residents are seen outside more frequently taking walks, enjoying the sunshine and soaking in another year’s season of new life.

The beauty of working with those in their senior years is the realization that no one ever gets tired of spring, regardless of how long one lives. I have yet to meet anyone who says, “...I sure wish spring would hurry along so that we could have the heat of summer...”!

Alongside these beautiful days are some of our own storm clouds and hail cannons. State government threatens cuts, delivery systems for senior care undergoes constant change, the budget debate in Washington, D.C. and Sacramento drags on like snails in our gardens looking for bright flowers to devour. Yet, our residents continue their healthy lives at their home called Palm Village and expect us to deliver on our promises and provide a harvest for their retired years. And we do.

Your help at this time of the year is much appreciated. We honor this time of spring and harvest with a feast called the guest chef dinner. This year it took place on April 7th at the new Kitchen/Dining facility of the Reedley, MB Church. Over 225 people (which is a record for us!) were present for a meal prepared by David Vartanian, of the Vintage Press of Visalia. David helped us celebrate the Living Legacy of Palm Village with a bountiful menu of incredible hors d’oeuvre of dates, almonds and local vegetables, white bean soup, pear and pecan salad, pork tenderloin with potatoes au gratin, carrots and aspara-



gus, nine-grain rolls and a delicious dessert of almond Tuille filled with ice cream and fresh fruit! It was a bountiful harvest indeed and was a complete Spring Spectacular of Food.

Thanks to those of you who helped us raise nearly \$30,000 for our Living Legacy fund that evening.

To enjoy some of the highlights of the dinner please look at a video posted at:

www.palmvillage.com/dinner



*Article by Charles Buller, M. Div
Palm Village Vice-President
of Advancement*

Memorial Contributors *January 1, 2011 - April 18, 2011*

GIFTS RECEIVED IN MEMORY OF:

ROBYN BRANDT

Richard and Kathleen Williams

KENNETH D. BROUSE

Tom and Sharon Newnham

VERNON DICK

Elizabeth Bartel
 Don and Lydia Beckenhauer
 Sam and Marvis Bergen
 Samuel and Debora Blankenship
 Jim Brandt
 Loren and Barbara Buller
 Vernon and Doris Buller
 Charles Dairson
 Henry and Erica Dick
 Ann Enns
 Don and Martha Enns
 Harold and Pat Enns
 Gene Ens
 Ronald and Connie Esau
 Saralyn Evans
 Robert and Elaine Falk
 Donald and Marie Faul
 Orville and Lois Fletcher
 Jake and Ruth Friesen
 Louise Friesen
 Peter Funk
 Jarrod and Laura Goentzel
 Darrell and Lila Golbek
 Joel and Charlene Golbek
 Carol Gouldy
 Henry and Marjorie Guichard
 Menno and Jane Harms
 Elaine Hatch
 Gerald and Julia Heinrichs
 Raymond and Jo Ann Hiebert
 Egon Hofer
 Insight For Living
 Edward and Marilyn Janzen
 Franklin and Judith Janzen
 Robert and Jackie Johnson
 Herbert and Marcella Jones
 Waneta Jost
 Eldon Jost
 Dallas and Betty Kelley
 Ethel Klassen
 Herman and Lulu Klassen
 Harold Kleinsasser
 Sharon Krause
 Walter and Helen Krause
 Robert and Wanda Kroeker

Athal and Barbara Lamb
 Dennis and Julia Langhofer
 Harriet Leonard
 Katherine Murbach-Penner
 MWS Group, LLC
 Gary and Arlene Nachtigall
 Martha Neufeld
 Laura Nickel
 Lavina Ollenburger
 Raymond and Bonnie O'Neil
 Helen Pauls
 David and Sheila Penner
 Margret Penner
 Edwin and Marjorie Ratzlaff
 Irwin and Dorothy Redekop
 Connie Reed
 William and Grace Reimer
 John and Mary Lee Schlesselman
 Floyd and Marie Siemens
 Bonnie Smith
 Miriam Sommers
 The Joshua Fund
 The Potter's House of Dallas, Inc.
 Florene Thiesen
 L.G. and Grace Thiessen
 Willie and Frances Thiessen
 Irma Toews
 Mennonite Brethren Church
 Upper Room S.S. Class
 Nathan Van Verst
 Robert and Carol Vix
 Phil Waldrep
 Mildred Warkentin
 Jerry and Beverly Weimer
 Allen and Linda Wiebe
 Gladys Wiebe
 Harry and Elvina Willems
 Lee and Lily Willems
 Ellard and La Verne Youngberg

ANNA FLAMING

John and Luella Mc Combs

DOLORES FRIESEN

Sam and Marvis Bergen
 Albert and Nancy Mae Ewert
 Norman and Doris Friesen
 Herman and Lulu Klassen
 Al and Mary Jane Lepp
 Laura Nickel
 L.G. and Grace Thiessen
 Willie and Frances Thiessen

NICK FRIESEN

Don and Lydia Beckenhauer
 R.J. and Marlene Goertzen
 Allen and Linda Wiebe

BILL HARBOUR

George and Karen Bongiorno

SUSIE HARMS

Lorraine Brandt
 Albert and Nancy Mae Ewert
 Martha Neufeld
 Adeline Pauls
 Margret Penner
 L.G. and Grace Thiessen
 Willie and Frances Thiessen
 Richard and Kathleen Williams

MARIE KLASSEN

Geri Biggs
 Ted Celaya
 Burgis Duerksen
 Albert and Nancy Mae Ewert
 Thomas Gonzales
 Egon Hofer
 Ferne Klaassen
 John and Edna Siemens, Jr
 Gloria Thiesen
 George and Myrtle Thiessen
 L.G. and Grace Thiessen
 Victor and Anna Wiens

ROSELLA KRAUSE

Paul and Beverley Rohrer

REV. HENRY SCHMIDT

Gloria Thiesen
 Edwin and Barbara Beam
 Chuck Buller
 Henry and Erica Dick
 Kenneth and Pricilla Elrich
 Arthur and Janet Enns
 Don Ens
 Henry and Marjorie Guichard
 Richard and Betsy Hofer
 Peter and Nancy Klassen
 Stanley and Ann Martens
 Ella and Art Penner
 Margret Penner
 Roland and Lois Reimer
 Dwight and Verna Roberts

Memorial Contributors

January 1, 2011 - April 18, 2011

GIFTS RECEIVED IN MEMORY OF:

Elvera Schmidt
 Doris Isaak Siebert
 Willie and Frances Thiessen
 Irma Toews
 Al and Dotty Warkentine
 Gladys Wiebe
 Harry and Elvina Willems

REGINA SUDERMAN

Anonymous
 Bill and Carol Braun
 Jake and Ruth Friesen
 Helen Janzen
 Louise and William Olinger
 Helen Pauls
 James and Verna Penner
 Margret Penner
 Nancy Suderman
 Mildred Warkentin

MARTIN THIESSEN

Nighel Huebert
 Harriet Leonard

ELEANOR TRANK

Charles and JoAnn Brandt

CORNELIUS UNRUH

Sam and Marvis Bergen
 Henry and Erica Dick
 Kenneth and Pricilla Elrich
 Harold and Pat Enns
 Marlow and Rachel Ens
 Jake and Ruth Friesen
 Louise Friesen
 Henry and Marjorie Guichard
 David and Rose Hall
 Egon Hofer
 Richard and Betsy Hofer
 Robert and Jackie Johnson
 Herbert and Marcella Jones

Abe and Arlene Klassen
 Edwin and Marjorie Ratzlaff
 John and Frieda Regier
 Verne and Darlene Siemens
 Bonnie Smith
 Gloria Thiesen
 Willie and Frances Thiessen
 Irma Toews
 Al and Dotty Warkentine
 Allen and Linda Wiebe
 Bob and Lucille Willems
 Harry and Elvina Willems
 Richard and Kathleen Williams

EDNA VEEH

Hilda and Lowell McFarlin

ANNA MAE WINTER

Jim and Linda Winter

When a senior needs a little extra help...

...Palm Village's Assisted Living Suites provide

- *Laundry and housekeeping service*
- *Attentive staff to help with medications*
- *Nutritious meals*
- *Planned activities*



325 sq. foot suite

Immediate Availability!

Call Jim Dueck today to arrange a personal visit:
(559) 638-6933
(800) 928-6545

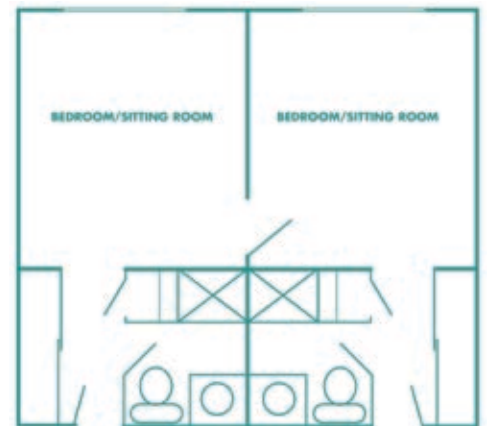

650 sq. foot suite

Living Legacy Donors

January 1, 2011 - April 18, 2011

Katherine Archinal	Louise Fast	Arthur and Beverly Klassen	Glen and Jennifer Quiring
Howard and Penny Ayers	Vernon and Doris Flaming	Ethel Klassen	El Roy and Erma Ratzlaff
George and Miyeko Baba	Orville and Lois Fletcher	Herman and Lulu Klassen	Reedley Mennonite
Leo and Rosalie Balakian	Doug and Ruth Fowler	Kent and Cathy Klassen	Brethren Church
David and Evelyn Bartel	Ken and Carol Fransen	Peter and Nancy Klassen	Les and Lovella Regier
Elizabeth Bartel	Roger and Lawanda Franz	Sharon and Don Klassen	Luann Regier
Peter and Salome Bartel	Barbara Friesen	Harold Kleinsasser	Marvin and Marciel Regier
Eleanor Beck	Glen and Cindy Friesen	Herald and Phyllis Kliever	David and Sandy Reimer
Sam and Marvis Bergen	Jake and Ruth Friesen	Kliever Packing	Dwight and Verna Roberts
Louise Bernsen	John and Harriet Friesen	Paul and Rachel Kliever	Lois Rosenfeld
Katherine Bonham	Loren Friesen	Pete and Dora Mae Kliever	SaveMart Supermarkets
Mark and Denise Brandt	Louise Friesen	Ruth Kliever	George and Marcia Sawatzky
Wayne and Eleanor Brandt	Marvin and Mary Ellen Friesen	Walter and Helen Krause	Bill and Darla Scharbach
Harry and Bertha Brown	Paul and Freda Friesen	Peggi Kriegbaum	Elmer and Moira Schmidt
Ron and Judy Brown	Timothy and Sharon Friesen	Robert and Wanda Kroeker	Elvera Schmidt
Chuck Buller	Ron and Norma Froese	Sylvia Leal	Michael and Cindy Schuil
Harley Buller	Jim and Mary Gaede	Harriet Leonard	Donald and Carol Seeks
Loren and Barbara Buller	John and Lori George	R.F. and M.M. Lewis	Bonnie Smith
Myron and Janine Buller	Geraldine L.Gerbrandt	Don Livezey	Brian and Alejandra Smith
Donald and Shirlye Burkett	Johnnie and Adena Goertzen	Norma Loewen	R.L. and Wilma Suderman
Karen Cooper	Ray and Pamela Goertzen	Norma J Loewen	Leroy and Vivian Swiney
Reed and Diane Decker	Joel and Frances Golbek	Wally and Esther Loewen	Jesus Tapia
Wilfred and Sandra Derksen	Ray and Mary June Goossen	Richard Lucero, Jr	Lou and Joanne Telesmanic
Brian and Laurie Diamant	Steven and Pamela Goossen	Donald and Mary MacNeill	Sal and Jeanette Tena
Henry and Erica Dick	F. Glen Grauman	Mike and Rosemary Manahan	Elizabeth Thiesen
James and Florence Dick	Henry and Marjorie Guichard	Joel Martens	Gloria Thiesen
Dinuba Mennonite	Robert Harless	Stanley and Ann Martens	Jacob and Mary Thiessen
Brethren Church	Glen and Helen Harvin	John and Luella Mc Combs	L.G. and Grace Thiessen
Bernhard Doerksen	Joanne Hayhurst	Duane and Gayle McCutchan	Willie and Frances Thiessen
Jim and Benti Dueck	Mark and Gail Hayward	Susan Mills	Irma Toews
Kim Dueck	L. Heinrichs	Michael and Beth Mock	Luella Unruh
Jennie Duerksen	Charles and Marilyn Hertzler	Roy and Janice Moore	Jim and Aldene Vogt
David and Carol Ediger	Carole Hirakawa	Cornelia Neale	Robert and Gloria Vogt
Thomas and Catherine Edwards	Brian and Kathy Hixson	Eddie and Verona Neufeld	Dennis and Brenda Wall
Mel Ekberg	Egon Hofer	Kenneth Neufeld	Sam and Chris Wall
Marlene Elliott	Nighel Huebert	Martha Neufeld	Larry and Paula Warkentin
Calvin and Marjorie Elrich	Stanley and Darlene Huebert	Laura Nickel	Leonard and Joyce Warkentin
Ann Enns	Agnes Isaac	Adeline Pauls	Marvin and Becky Warkentin
Earl and Esther Enns	Joel and Judith Isaak	Bradley and Charis Pauls	Vickie Weaver
Kenneth Enns	Steve and Elaine Isaak	Ed Pauls	Wes Pak Sales, Inc.
Enns Packing Company, Inc.	Irvin and Kathryn Jantzen	Vernon and Bertha Pauls	Anne Widaman
Victor and Katherine Enns	Alice Janzen	David and Sheila Penner	Franklin and Frieda Wiebe
Don Ens	Edward and Marilyn Janzen	Ella and Art Penner	Delbert and Linda Wiest
Douglas and Jill Ensz	Robert and Jackie Johnson	Margret Penner	George Willems
Mary Entz	Elmer and Loree Jost	Martin and Carolyn Penner	Harry and Elvina Willems
Charles and Rubena Ewell	Waneta Jost	Peter and Jean Penner	Patricia Willems
Albert and Nancy Mae Ewert	A.G. Kirchner	Gerry and Kim Peters	Walt and Patricia Willems
Dennis and Connie Fast	Anne Klassen	Jonie and Sarah Peters	Yanez Construction

STORIES FROM RESIDENTS AND THEIR FAMILIES



For the last several months, we have been interviewing residents and their families so we could have personal stories for articles in the local newspaper. Here are some excerpts from those articles.

"We looked at other facilities and after several interviews, it became obvious that Palm Village was a loving retirement community for Mom."

– Resident's daughter

"Now that we live here, I never think about my age. We jump for joy for our lifestyle here. We wish we had moved here sooner!"

– Palm Village Resident

"With the encouragement of a family doctor, the decision was made that assisted living would surely be a blessing for all of us."

– Resident's daughter

"I live at a place where I am well taken care of, and I really enjoy living here."

– Palm Village Resident



P.O. BOX 1028
REEDLEY, CA 93654

NON-PROFIT ORG.
U.S. POSTAGE
PAID
FRESNO, CA
Permit No. 2627



COA 170 Lic. #100404809 • February, 2011



The Palm Villager is a publication of Palm Village Retirement Community, a mission agency sponsored by the Bethany and Butler Mennonite churches in Fresno and by the Mennonite Brethren churches of Dinuba, Kingsburg and Reedley. (559) 638-6933 • www.palmvillage.com

**President and CEO, David K Reimer • Director of Marketing, Jim Dueck
Vice-President of Advancement, Charles Buller**